

3,035 SF Former Bank at Market at Southside

2811 S. Orange Avenue | Orlando, FL

Retail For Lease



Jorge Rodriguez, CCIM
Executive Vice President
+1 407 362 6141
jorge.rodriguez@colliers.com

Chris Alders
Vice President
+1 407 362 6142
chris.alders@colliers.com



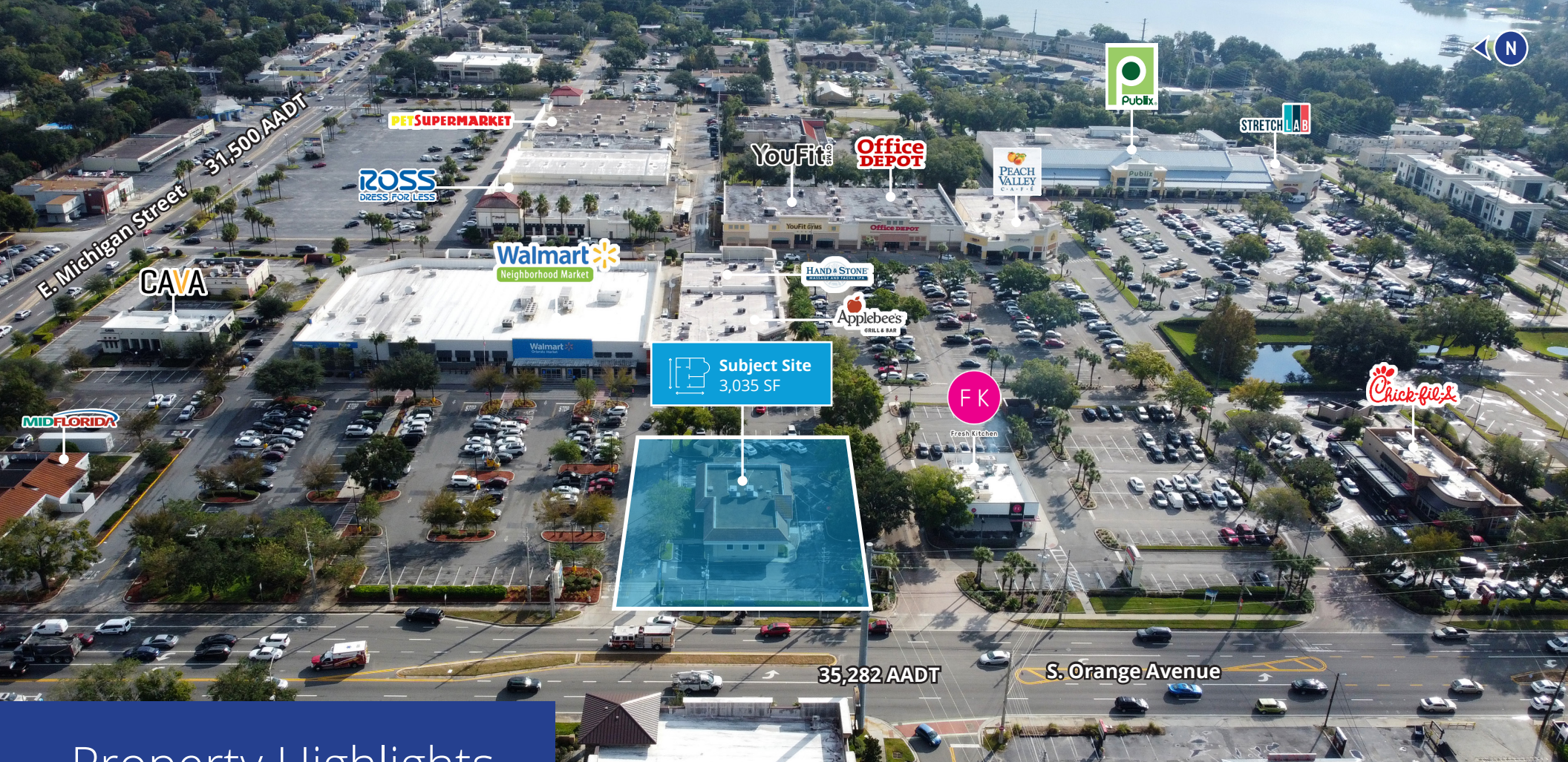

Property Highlights

- 3,035 SF available for lease
- Building is on 0.57-acres
- 18 parking spaces
- Two drive-thru lanes
- Ideal for bank/retail/restaurant/medical users

- Frontage along S. Orange Avenue
- 1/2 mile south of downtown Orlando
- Close proximity to I-4 and SR 408
- Strong daytime population of 219,000+ within 3 miles
- Located south of Orlando Health's main campus - 1,882 beds

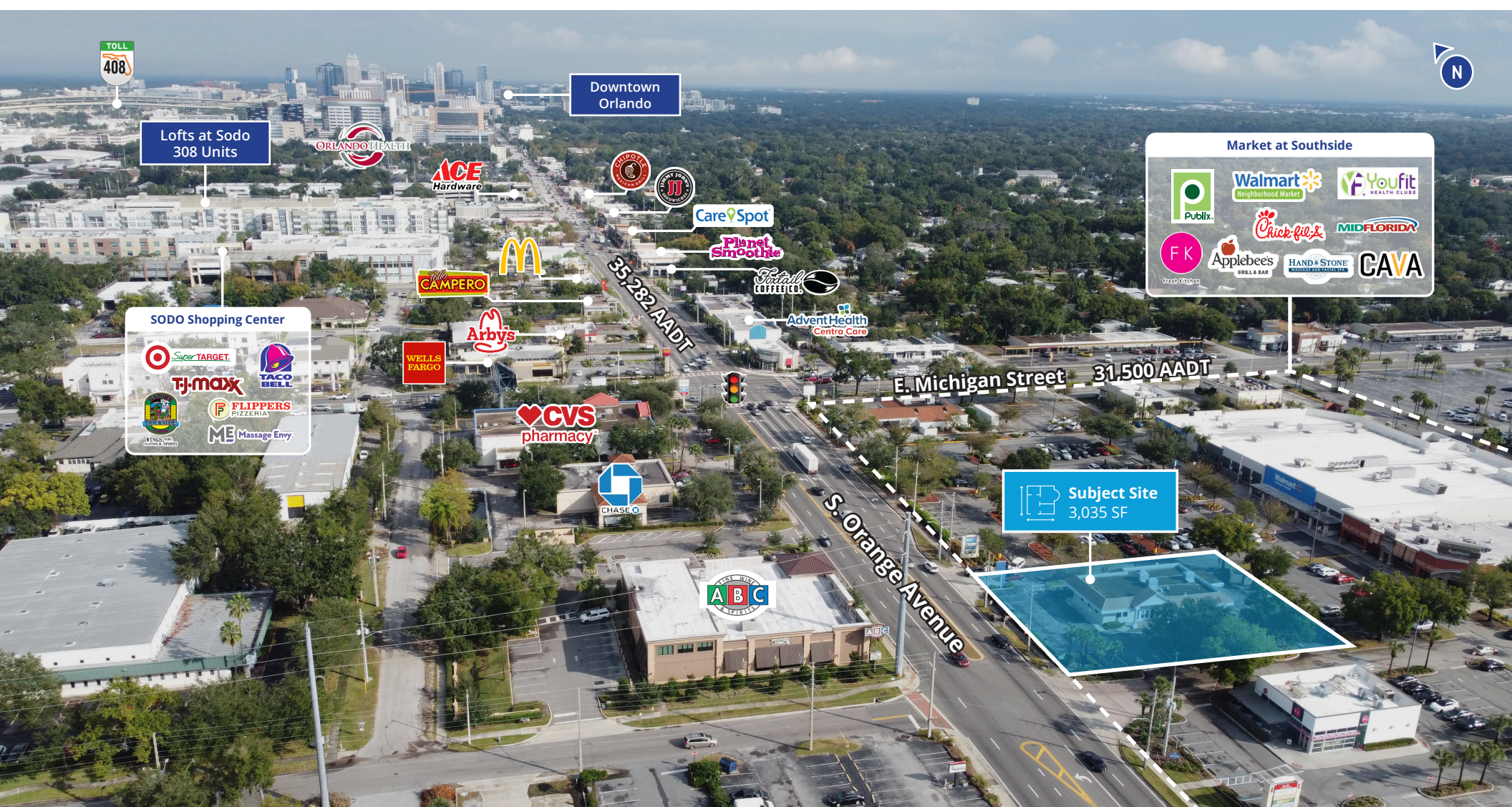

Area Demographics



Population

1-Mile: 9,849
3-Mile: 126,980
5-Mile: 321,872



Daytime Population

1-Mile: 49,132
3-Mile: 219,052
5-Mile: 462,859



Average HH Income

1-Mile: \$115,961
3-Mile: \$84,433
5-Mile: \$84,447



Households

1-Mile: 4,332
3-Mile: 54,492
5-Mile: 131,481

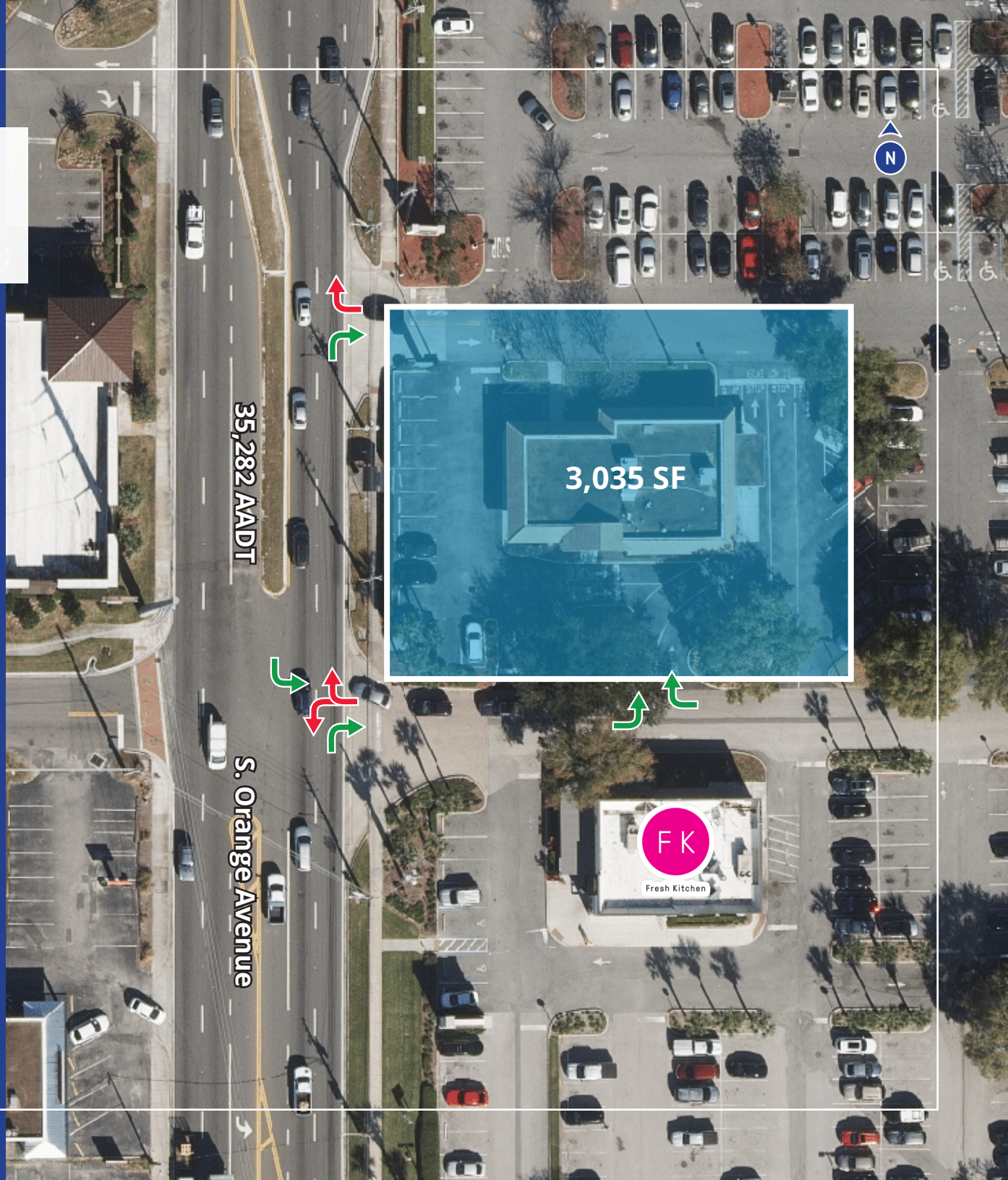

Contact Us

Jorge Rodriguez, CCIM
Executive Vice President
+1 407 362 6141
jorge.rodriguez@colliers.com

Chris Alders
Vice President
+1 407 362 6142
chris.alders@colliers.com

This document has been prepared by Colliers International for advertising and general information only. Colliers International makes no guarantees, representations or warranties of any kind, expressed or implied, regarding the information including, but not limited to, warranties of content, accuracy and reliability. Any interested party should undertake their own inquiries as to the accuracy of the information. Colliers International excludes unequivocally all inferred or implied terms, conditions and warranties arising out of this document and excludes all liability for loss and damages arising there from. This publication is the copyrighted property of Colliers International and/or its licensor(s). ©2023. All rights reserved.

